

ATMOS C 161 Aspirator / ATMOS C 261 Aspirator

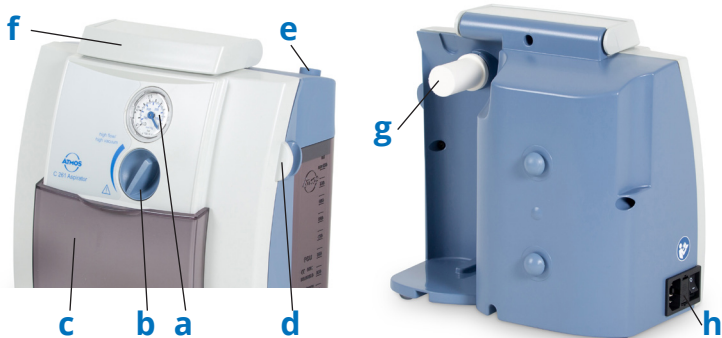

- a Vacuum display / Vakuum display
- b Vacuum regulator / Vakuum regulator
- c Sliding cover for covering the controls / Beskyttelsescover til kontrolpanelet
- d Hose holder / Slangeholder
- e Connection for suction hose / Tilslutning til sugeslange
- f Carry handle / Bærehåndtag
- g Hydrophobic DDS bacterial and viral filter / Vandafvisende DDS bakterie- og virusfilter
- h Mains connection with on/off switch / Nettetilslutning med tænd/sluk knap

Main function

Temporary and spontaneous suction of suction material (including secretions, blood, serum fluids, food particles) from the oral cavity, pharynx and bronchial system

Suction during ENT treatments

Hovedfunktion

Midlertidig og spontan sugning af sugemateriale (inklusive sekret, blod, serumvæsker, madpartikler) fra mundhulen, svælget og bronkialsystemet

Sugning under Øre-Næse-Hals-behandlinger

Cleaning instructions

Surface	For continued use on the same patient					
	For use on another patient	If contaminated	After each suction procedure	1x per day	1x per week	Every 2 weeks
Exchange the DDS bacterial and viral filter	X	X				X
Rinse the suction hose	X		X			
Disinfect the suction hose	X			X		
Exchange the suction hose						X
Exchange the fingertip	X			X		
Empty the secretion canister	X		X			
Rinse the secretion canister	X		X			
Disinfect the secretion canister	X			X		
Rinse the canister lid components	X		X			
Disinfect the canister lid components	X			X		
Clean the device surface	X	X			X	
Wipe down the device surface with disinfectant	X	X			X	
Rinse the vacuum hose	X			X		
Disinfect the vacuum hose	X			X		
Disinfect the hose connector	X					X

Rengøringsvejledning

Overflade	Til forsæt brug på samme patient						
	Til brug på en anden patient	Hvis kontamineret	Efter hver sugeprocedure	1x om dagen	1x om ugen	Hver 2. uge	Hver 4. uge
Udskift DDS bakterie- og virusfilteret	X	X				X	
Skyl sugeslangen	X		X				
Desinficer sugeslangen	X			X			
Udskift sugeslangen							X
Udskift slangens fingertip	X			X			
Tøm sekretbeholderen	X		X				
Skyl sekretbeholderen	X		X				
Desinficer sekretbeholderen	X			X			
Skyl beholderens låg-komponenter	X		X				
Desinficer beholderens låg-komponenter	X			X			
Rengør enhedens overflade	X	X			X		
Tør enhedens overflade af med desinfektionsmiddel	X	X			X		
Skyl vakuumslangen	X			X			
Desinficer vakuumslangen	X			X			
Desinficer slangetilslutningen	X						X

Before suction / Før sugning

1

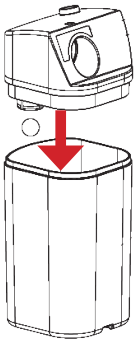

2

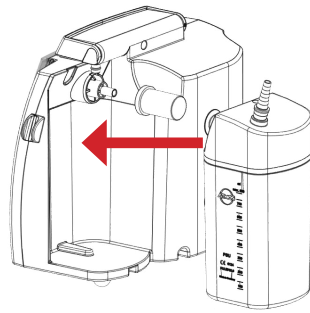

3



4

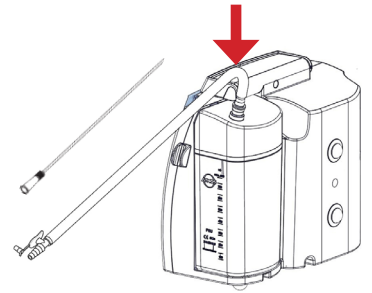

After suction / Efter sugning

5



6

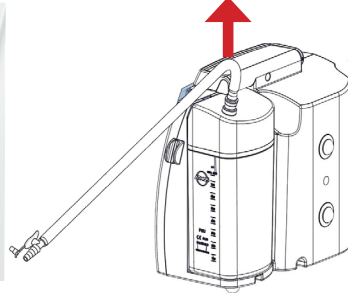

7

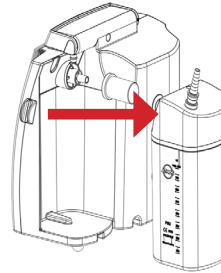

8

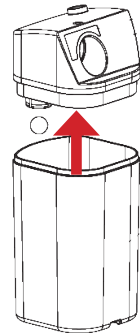

ATTENTION / OBS

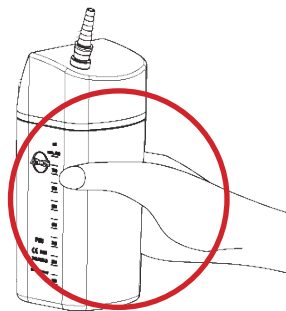

This card does not replace the operating instructions!
Dette kort erstatter ikke brugsanvisningen!



Please note the operating instructions!
Vær opmærksom på brugsanvisningen!

CE 0124



MedizinTechnik

ATMOS MedizinTechnik GmbH & Co. KG

Ludwig-Kegel-Str. 16

79853 Lenzkirch / Germany

Phone: +49 7653 689-0

info@atmosmed.de